

# FOR LEASE

**Building #2, Suite 280**  
2119 SE Columbia Way, Vancouver, WA



- 7,883 Total SF available divisible to 5,860
- Includes 1,776 SF Office
- 277/480 Volt Power
- 4 Grade Level Doors
- Sprinklered Bldg.
- 14' Clear Height

**Rates:**  
\$.35/psf/month shell + NNN  
\$.65/psf/month surcharge  
for office



For more information contact:  
**Dave Brown at 360-735-8001**  
[www.columbiacommercial.com](http://www.columbiacommercial.com)



1672 WILLAMETTE FALLS DR., SUITE E  
PO Box 46  
West Linn, Oregon 97068  
PH: (503) 650-5300  
FX: (503)650-5343



9120 NE Vancouver Mall Loop, SUITE 200  
PO Box 820406  
VANCOUVER, WASHINGTON 98682  
PH: (360) 735-8001  
FX: (360) 735-8033

**COLUMBIA COMMERCIAL PROPERTIES, LLC**

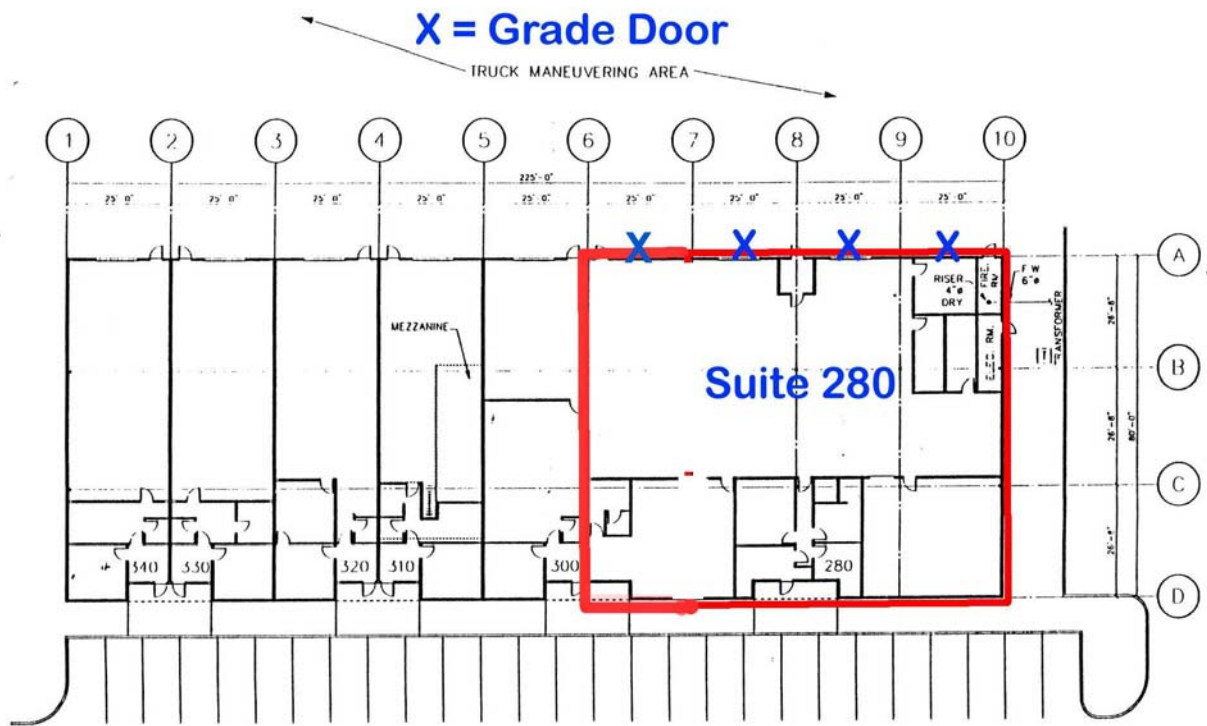

BUILDING AREA: 18,000 SQ FT  
 ADDRESS: 2119 S E COLUMBIA WAY  
 PARKING: 51 SPACES - 2 B/1  
 CLEAR HEIGHT: 14'-0"  
 DOCK HIGH DOORS: 0  
 GRADE LEVEL DOORS: 7

**BUILDING # 2**  
 SCALE: 1" = 30'-0"  
 0' 10' 25' 50' 75'



COLUMBIA BUSINESS CENTER  
 UPDATED FEB., 1996